

40/49-51 Mitchell Road Brookvale NSW

2 🚗

Located in the tightly held boutique strata block of Major Mitchell. Well presented Industrial unit - Offering a unique opportunity now occupy. Situated on the first floor, high clearance factory, plenty of natural light throughout and benefits from easy truck access via a one-way circulation, with direct access from Mitchell Road. This one ticks all the boxes.

Price : \$45,000 + GST pa
Building Size : 172 sqm
Land Size : 137 sqm
View : <https://www.bridgerealty.com.au/lease/nsw/northern-beaches/brookvale/commercial/industrial/7993303>

Additional Features Include:

- * DA Approved Mezzanine
- * Fully renovated bathroom including Shower
- * Air-conditioning
- * Spacious office with sink and benchtops
- * Kitchenette
- * 3 Phase power
- * Rollershutter access



Andrew Holland
0423 314 862

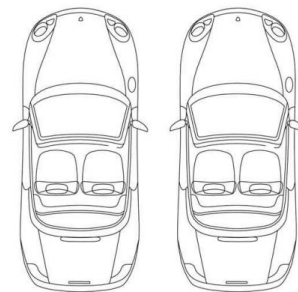
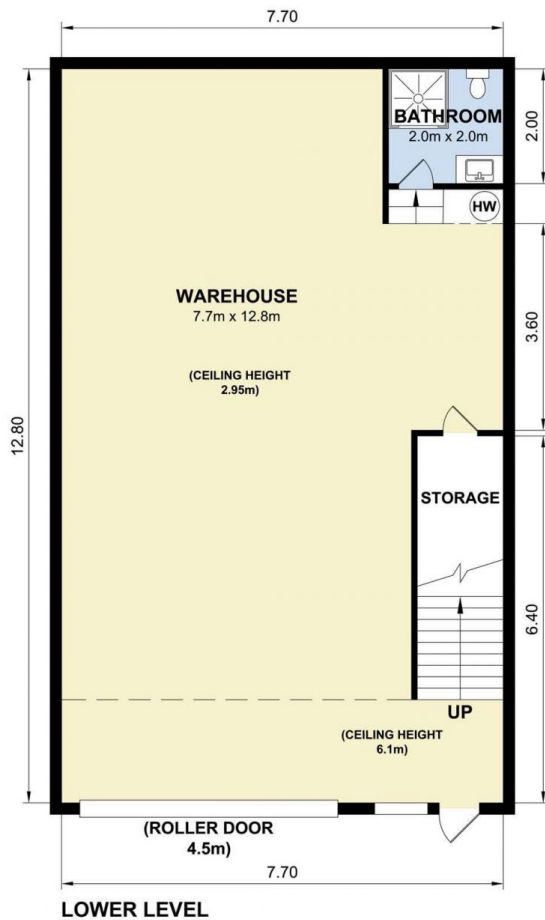
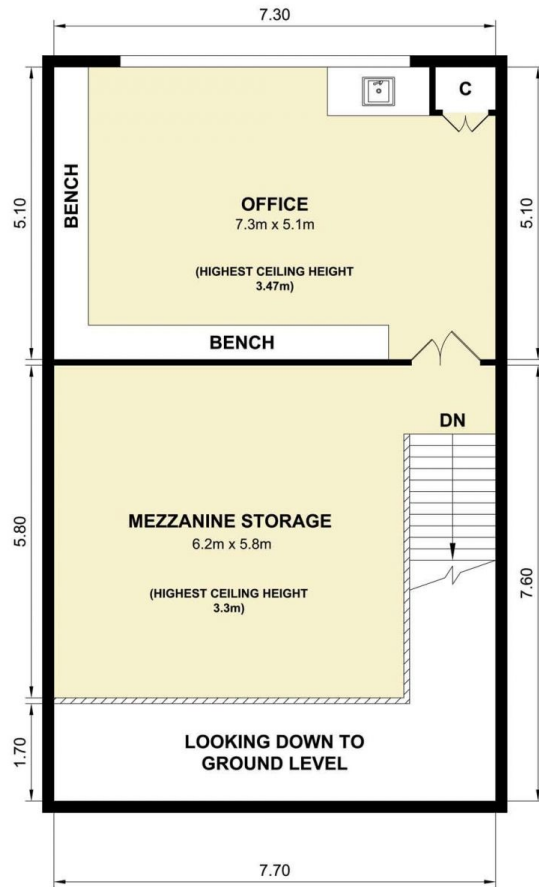

2 CAR SPACES



40/49-51 Mitchell Road, Brookvale

Measurements are approximate. Not to scale. Illustrative purposes only. Open2view does not take any responsibility for any information supplied.