



Warriewood

15 

Impressive and attractive, large scale Industrial Facility now offering For Sale for the first time in 25 years ! Rare Opportunity to capitalise on a well maintained factory area in Central Warriewood. Sunny East facing Aspect, with wide frontage. Property Benefits Include:

- * Clear span throughout
- * High Clearance Factory Space
- * 3 Phase power throughout
- * Heavy Truck Access / Perfect for containers
- * Hi-Bay warehouse with oversized roller-shutter access
- * M & F Toilets w/shower
- * Lunch room
- * Dual carriage access driveway for easy vehicle movement
- * 2 x kitchenette
- * Air-conditioned Office

Price : Contact Agent
Building Size : 856 sqm
Land Size : 856 sqm
View : <https://www.bridgerealty.com.au/sale/ns-w/northern-beaches/warriewood/commercial/industrial/8070870>



Andrew Holland
0423 314 862

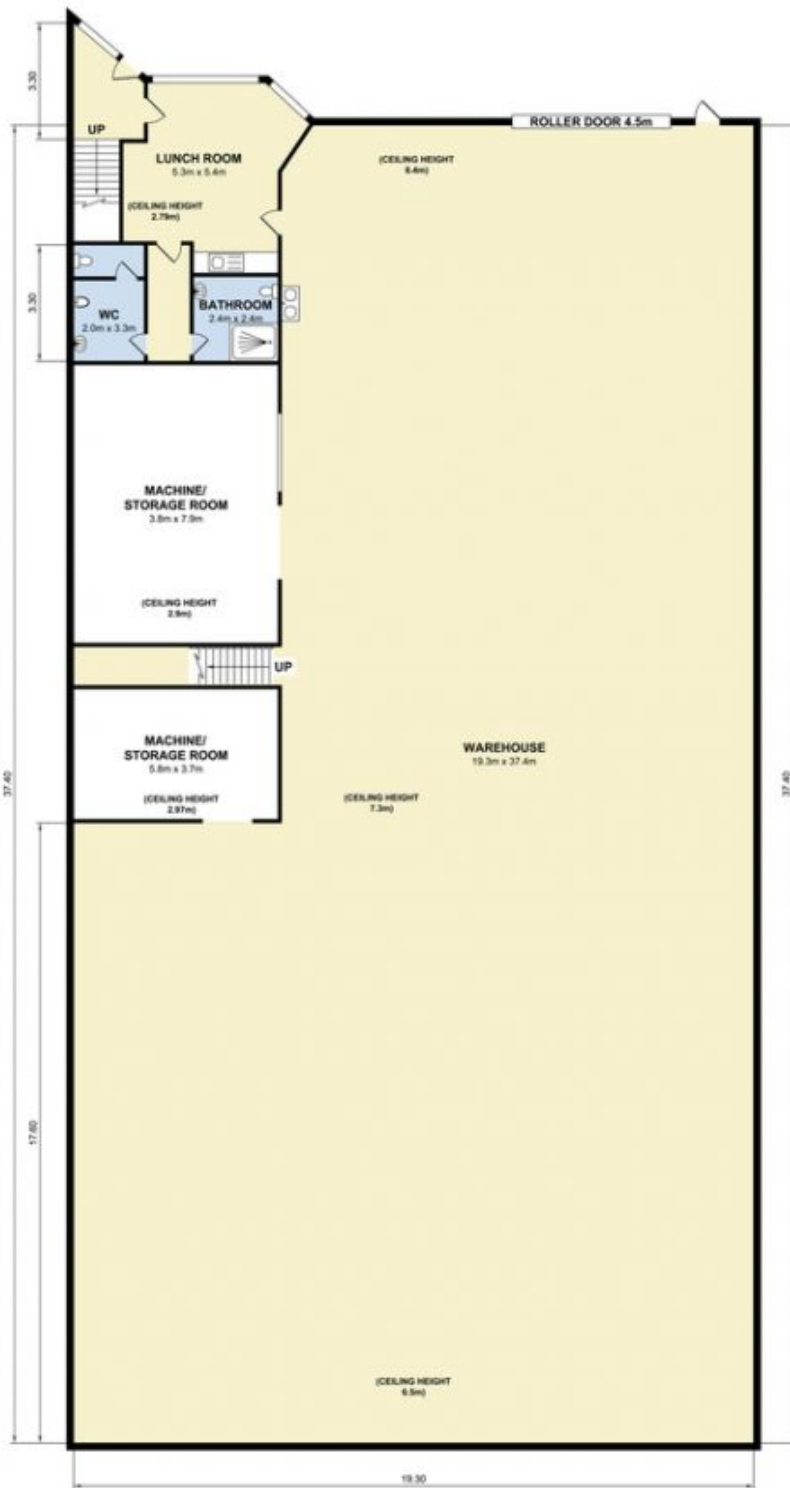

5/7 Jubilee Ave, Warriewood

Measurements are approximate. Not to scale. Illustrative purposes only. Open2view does not take any responsibility for any information supplied.